

A系列滚子链轮 Sprocket For Roller Chain-A Series

单排链轮 ISO/R 04C ANSI 25 Sprockets for Roller Chains-Simplex

配套链条尺寸 Chain Size

节距 Pitch	0.250"
滚子直径 Roller	0.130"
内节内宽 Internal width	0.125"

链轮尺寸 Sprocket Size

齿端圆弧R3 Tooth radius	0.267"
圆弧深度C Radius width	0.040"
齿宽B1 Tooth width	0.110"

A 型

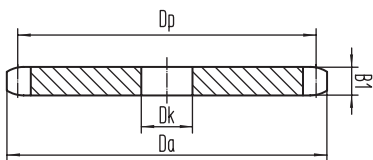

B 型

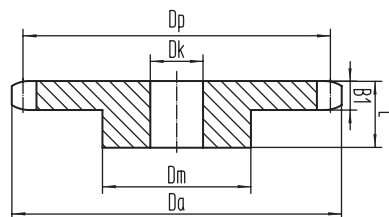

齿数 tooth number	节圆径 Pitch diameter	齿顶圆 addendum circle	A 型		B 型	
			孔径 bore diameter	凸台 boss	孔径 bore diameter	总厚度 aggregate thickness
Z	Dp	Da	Dk	dm	Dk	L
9	0.74	0.840		0.438	0.250	0.500
10	0.81	0.920		0.500	0.250	0.500
11	0.888	1.000		0.563	0.250	0.500
12	0.966	1.080		0.625	0.250	0.500
13	1.045	1.160		0.719	0.250	0.500
14	1.124	1.250		0.813	0.250	0.500
15	1.203	1.330		0.891	0.250	0.500
16	1.282	1.410		0.969	0.250	0.500
17	1.361	1.490		1.031	0.250	0.500
18	1.44	1.570	0.250	2.125	0.250	0.500
19	1.519	1.650	0.250	1.219	0.250	0.500
20	1.599	1.730	0.250	1.281	0.250	0.625
21	1.678	1.810	0.375	1.375	0.250	0.625
22	1.757	1.890	0.375	1.438	0.250	0.625
23	1.836	1.970	0.375	1.500	0.250	0.625
24	1.916	2.050	0.375	1.500	0.375	0.625
25	1.995	2.130	0.375	1.500	0.375	0.625
26	2.075	2.210	0.375	1.500	0.375	0.625
27	2.154	2.290	0.375	1.500	0.375	0.625
28	2.233	2.370	0.375	1.500	0.375	0.625
29	2.313	2.450	0.375	1.500	0.375	0.625
30	2.392	2.530	0.375	2.000	0.375	0.625
31	2.472	2.610	0.375	2.000	0.375	0.625
32	2.551	2.690	0.375	2.000	0.375	0.625
33	2.631	2.770	0.375	2.000	0.375	0.625
34	2.71	2.850	0.375	2.000	0.375	0.625
35	2.789	2.930	0.375	2.000	0.375	0.750
36	2.869	3.010	0.375	2.000	0.375	0.750
37	2.948	3.090	0.500	2.000	0.500	0.750
38	3.028	3.170	0.500	2.000	0.500	0.750
39	3.107	3.250	0.500	2.000	0.500	0.750
40	3.187	3.330	0.500	2.000	0.500	0.750
41	3.266	3.410	0.500	2.000	0.500	0.750
42	3.346	3.490	0.500	2.000	0.500	0.750

齿数 tooth number	节圆径 Pitch diameter	齿顶圆 addendum circle	A 型		B 型	
			孔径 bore diameter	凸台 boss	孔径 bore diameter	总厚度 aggregate thickness
Z	Dp	Da	Dk	dm	Dk	L
43	3.430	3.570	0.500	2.000	0.500	0.750
44	3.510	3.650	0.500	2.000	0.500	0.750
45	3.590	3.730	0.500	2.000	0.500	0.750
46	3.670	3.800	0.500	2.000	0.500	0.750
47	3.750	3.880	0.500	2.000	0.500	0.750
48	3.830	3.960	0.500	2.000	0.500	0.750
49	3.910	4.040	0.500	2.000	0.500	0.750
50	3.990	4.120	0.500	2.000	0.500	0.750
51	4.070	4.200	0.500	2.000	0.500	0.750
52	4.150	4.280	0.500	2.000	0.500	0.750
53	4.230	4.360	0.500	2.000	0.500	0.750
54	4.300	4.440	0.500	2.000	0.500	0.750
55	4.380	4.520	0.500	2.000	0.500	0.750
56	4.460	4.600	0.500	2.000	0.500	0.750
57	4.540	4.680	0.500	2.000	0.500	0.750
58	4.620	4.760	0.500	2.000	0.500	0.750
59	4.700	4.840	0.500	2.000	0.500	0.750
60	4.780	4.920	0.500	2.000	0.500	0.750
61	4.860	5.000	0.500	2.000	0.500	0.750
62	4.940	5.080	0.500	2.000	0.500	0.750
63	5.020	5.160	0.500	2.000	0.500	0.750
64	5.100	5.240	0.500	2.000	0.500	0.750
65	5.180	5.320	0.500	2.000	0.500	0.750
66	5.260	5.400	0.500	2.000	0.500	0.750
67	5.340	5.480	0.500	2.000	0.500	0.750
68	5.420	5.560	0.500	2.000	0.500	0.750
69	5.500	5.640	0.500	2.000	0.500	0.750
70	5.580	5.720	0.500	2.000	0.500	0.750
71	5.660	5.800	0.500	2.000	0.500	0.750
72	5.740	5.880	0.500	2.000	0.500	0.750

注: 1. 外形尺寸按上表, 齿部参数在不指明的情况按照 ISO 606 加工。其余标准: DIN 8187/ BS 228 /JIS 1802

2. 材质: 不指定则为 45 GB/T699

3. 带 "*" 的凸缘为焊接件。

输送机
Conveyor Chains

曳引链
Leaf Chains

传动链
Driving Chains

键槽和螺纹
Keyway And Thread

A 系列滚子链轮
Sprocket - A Series

B 系列滚子链轮
Sprocket - B Series

双节距链轮
Double Pitch Sprocket

双驱链轮
Double-Drive Sprocket

同步带轮
Synchronous Pulley

A系列滚子链轮 Sprocket For Roller Chain-A Series

单排链轮 ISO/R 06C ANSI 35 Sprockets for Roller Chains-Simplex

配套链条尺寸 Chain Size

节距 Pitch	0.375"
滚子直径 Roller	0.200"
内节内宽 Internal width	0.188"

链轮尺寸 Sprocket Size

齿端圆弧R3 Tooth radius	0.397"
圆弧深度C Radius width	0.040"
齿宽B1 Tooth width	0.168"

A型

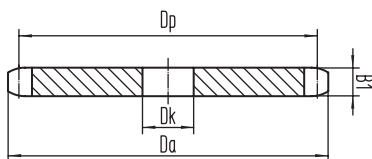

B型

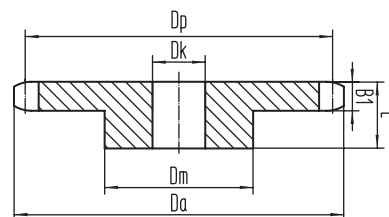

齿数 tooth number	节圆径 Pitch diameter	齿顶圆 addendum circle	A型		B型		齿数 tooth number	节圆径 Pitch diameter	齿顶圆 addendum circle	A型		B型	
			孔径 bore diameter	凸台 boss	孔径 bore diameter	总厚度 aggregate thickness				孔径 bore diameter	凸台 boss	孔径 bore diameter	总厚度 aggregate thickness
Z	Dp	Da	Dk	dm	Dk	L	Z	Dp	Da	Dk	dm	Dk	L
8	0.980	1.130		0.750	0.375	0.750	42	5.019	5.230	0.593	2.250	0.625	1.000
9	1.100	1.260		0.844	0.375	0.750	43	5.138	5.350	0.593	2.250	0.625	1.000
10	1.220	1.380		0.969	0.375	0.750	44	5.257	5.470	0.593	2.250	0.625	1.000
11	1.340	1.500		1.063	0.375	0.750	45	5.376	5.590	0.593	2.250	0.625	1.000
12	1.450	1.620		1.219	0.500	0.750	46	5.496	5.710	0.593	2.250	0.625	1.000
13	1.570	1.750		1.250	0.500	0.750	47	5.615	5.830	0.593	2.250	0.625	1.000
14	1.690	1.870		1.250	0.500	0.750	48	5.734	5.950	0.593	2.250	0.625	1.000
15	1.810	1.990	0.500	1.344	0.500	0.750	49	5.853	6.070	0.593	2.250	0.625	1.000
16	1.930	2.110	0.500	1.469	0.500	0.750	50	5.973	6.190	0.593	2.250	0.625	1.000
17	2.050	2.230	0.500	1.594	0.500	0.750	51	6.092	6.300	0.593	2.250	0.625	1.000
18	2.160	2.350	0.500	1.719	0.500	0.750	52	6.211	6.420	0.593	2.250	0.625	1.000
19	2.280	2.470	0.500	1.844	0.500	0.750	53	6.331	6.540	0.593	2.250	0.625	1.000
20	2.400	2.590	0.500	1.938	0.500	0.750	54	6.450	6.660	0.593	2.250	0.625	1.000
21	2.520	2.710	0.500	2.000	0.500	0.875	55	6.569	6.780	0.719	2.250	0.750	1.000
22	2.640	2.830	0.500	2.000	0.500	0.875	56	6.689	6.900	0.719	2.250	0.750	1.000
23	2.760	2.950	0.500	2.000	0.500	0.875	57	6.808	7.020	0.719	2.250	0.750	1.000
24	2.880	3.070	0.500	2.000	0.500	0.875	58	6.927	7.140	0.719	2.250	0.750	1.000
25	3.000	3.190	0.500	2.000	0.500	0.875	59	7.046	7.260	0.719	2.250	0.750	1.000
26	3.120	3.310	0.500	2.000	0.500	0.875	60	7.166	7.380	0.719	2.250	0.750	1.000
27	3.240	3.430	0.500	2.000	0.500	0.875	61	7.285	7.500	0.719	2.250	0.750	1.000
28	3.350	3.550	0.500	2.000	0.500	0.875	62	7.404	7.620	0.719	2.250	0.750	1.000
29	3.470	3.670	0.500	2.000	0.500	0.875	63	7.524	7.740	0.719	2.250	0.750	1.000
30	3.590	3.790	0.500	2.000	0.500	0.875	64	7.643	7.860	0.719	2.250	0.750	1.000
31	3.710	3.910	0.625	2.000	0.500	0.875	65	7.762	7.980	0.719	2.250	0.750	1.000
32	3.830	4.030	0.625	2.000	0.500	0.875	66	7.882	8.100	0.719	2.250	0.750	1.000
33	3.950	4.150	0.625	2.250	0.625	0.875	67	8.001	8.220	0.719	2.250	0.750	1.000
34	4.070	4.270	0.625	2.250	0.625	0.875	68	8.120	8.340	0.719	2.250	0.750	1.000
35	4.190	4.390	0.625	2.250	0.625	0.875	69	8.240	8.460	0.719	2.250	0.750	1.000
36	4.310	4.510	0.625	2.250	0.625	0.875	70	8.359	8.580	0.719	2.250	0.750	1.000
37	4.430	4.630	0.593	2.250	0.625	1.000	72	8.598	8.810	0.719	2.250	0.750	1.000
38	4.550	4.750	0.593	2.250	0.625	1.000	80	9.552	9.770	0.719	2.250	0.750	1.000
39	4.670	4.870	0.593	2.250	0.625	1.000	84	10.030	10.250	0.719	2.250	0.750	1.000
40	4.780	4.990	0.593	2.250	0.625	1.000	96	11.462	11.680	0.719	2.250	0.750	1.000
41	4.900	5.110	0.593	2.250	0.625	1.000	112	13.371	13.590	0.719	2.250	0.750	1.000

注: 1. 外形尺寸按上表, 齿部参数在不指明的情况按照 ISO 606 加工。其余标准: DIN 8187/ BS 228 /JIS 1802

2. 材质: 不指定则为 45 GB/T699

3. 带“*”的凸缘为焊接件。

单排链轮 ISO/R 085 ANSI 41 Sprockets for Roller Chains-Simplex

配套链条尺寸 Chain Size

节距 Pitch	0.500"
滚子直径 Roller	0.306"
内节内宽 Internal width	0.250"

链轮尺寸 Sprocket Size

齿端圆弧R3 Tooth radius	0.511"
圆弧深度C Radius width	0.051"
齿宽B1 Tooth width	0.227"

A 型

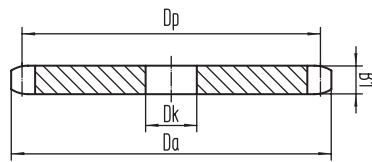

B 型

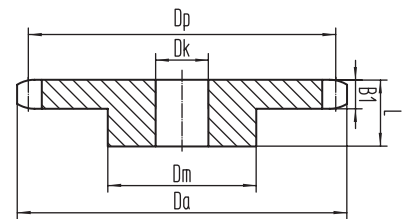

齿数 tooth number	节圆径 Pitch diameter	齿顶圆 addendum circle	A 型		B 型		齿数 tooth number	节圆径 Pitch diameter	齿顶圆 addendum circle	A 型		B 型	
			孔径 bore diameter	凸台 boss	孔径 bore diameter	总厚度 aggregate thickness				孔径 bore diameter	凸台 boss	孔径 bore diameter	总厚度 aggregate thickness
Z	Dp	Da	Dk	dm	Dk	L	Z	Dp	Da	Dk	dm	Dk	L
8	1.310	1.510		0.984	0.375	0.875	42	6.691	6.970	0.719	3.500	0.750	1.063
9	1.470	1.670		1.125	0.375	0.875	43	6.850	7.130	0.719	3.500	0.750	1.063
10	1.620	1.840		1.250	0.500	0.875	44	7.009	7.290	0.719	3.500	0.750	1.063
11	1.780	2.000		1.438	0.500	0.875	45	7.168	7.450	0.719	3.500	0.750	1.063
12	1.940	2.170		1.563	0.500	0.875	46	7.327	7.610	0.719	3.500	0.750	1.063
13	2.090	2.330		1.563	0.500	0.875	47	7.486	7.770	0.719	3.500	0.750	1.063
14	2.250	2.490		1.750	0.500	0.875	48	7.645	7.930	0.719	3.500	0.750	1.063
15	2.410	2.650	0.625	1.091	0.500	0.875	49	7.804	8.090	0.719	3.500	0.750	1.063
16	2.570	2.810	0.625	2.063	0.625	0.875	50	7.963	8.250	0.719	3.500	0.750	1.063
17	2.730	2.970	0.625	2.234	0.625	1.000	51	8.123	8.410	0.719	3.500	0.750	1.063
18	2.880	3.140	0.625	2.375	0.625	1.000	52	8.282	8.570	0.719	3.500	0.750	1.063
19	3.040	3.300	0.625	2.469	0.625	1.000	53	8.441	8.730	0.719	3.500	0.750	1.063
20	3.200	3.460	0.625	2.750	0.625	1.000	54	8.600	8.880	0.719	3.500	0.750	1.063
21	3.360	3.620	0.625	2.875	0.625	1.000	55	8.759	9.040	0.719	3.500	0.750	1.063
22	3.520	3.780	0.625	3.000	0.625	1.000	56	8.918	9.200	0.719	3.500	0.750	1.063
23	3.680	3.940	0.625	3.188	0.625	1.000	57	9.077	9.360	0.719	3.500	0.750	1.063
24	3.840	4.100	0.625	3.250	0.625	1.000	58	9.236	9.520	0.719	3.500	0.750	1.063
25	3.990	4.260	0.625	3.250	0.625	1.000	59	9.395	9.680	0.719	3.500	0.750	1.063
26	4.150	4.420	0.625	3.250	0.625	1.000	60	9.554	9.840	0.719	3.500	0.750	1.063
27	4.310	4.580	0.625	3.250	0.625	1.000	61	9.713	10.000	0.719	4.000	0.750	1.188
28	4.470	4.740	0.625	3.250	0.625	1.000	62	9.872	10.160	0.719	4.000	0.750	1.188
29	4.630	4.900	0.625	3.250	0.625	1.000	63	10.031	10.320	0.719	4.000	0.750	1.188
30	4.790	5.060	0.594	3.250	0.625	1.000	64	10.191	10.480	0.719	4.000	0.750	1.188
31	4.950	5.220	0.594	3.250	0.625	1.000	65	10.350	10.640	0.719	4.000	0.750	1.188
32	5.110	5.380	0.594	3.250	0.625	1.000	66	10.509	10.800	0.719	4.000	0.750	1.188
33	5.270	5.540	0.594	3.250	0.625	1.000	67	10.668	10.960	0.719	4.000	0.750	1.188
34	5.420	5.700	0.594	3.250	0.625	1.000	68	10.827	11.110	0.719	4.000	0.750	1.188
35	5.580	5.860	0.594	3.250	0.625	1.000	69	10.986	11.270	0.719	4.000	0.750	1.188
36	5.740	6.020	0.594	3.250	0.625	1.000	70	11.145	11.430	0.719	4.000	0.750	1.188
37	5.900	6.170	0.719	3.250	0.750	1.063	72	11.463	11.750	0.719	4.000	0.750	1.188
38	6.060	6.330	0.719	3.250	0.750	1.063	80	12.736	13.030	0.719	4.000	0.750	1.188
39	6.220	6.490	0.719	3.250	0.750	1.063	84	13.373	13.660	0.719	4.000	0.750	1.188
40	6.380	6.650	0.719	3.250	0.750	1.063	96	15.282	15.570	0.938	4.000	1.000	1.188
41	6.540	6.810	0.719	3.500	0.750	1.063	112	17.828	18.120	0.938	4.000	1.000	1.188

注: 1. 外形尺寸按上表, 齿部参数在不指明的情况按照 ISO 606 加工。其余标准: DIN 8187/ BS 228 /JIS 1802

2. 材质: 不指定则为 45 GB/T699

3. 带“*”的凸缘为焊接件。

A系列滚子链轮 Sprocket For Roller Chain-A Series

■ 双排链轮 ISO/R 08A ANSI 40 Sprockets for Roller Chains-Duplex

配套链条尺寸 Chain Size

节距 Pitch	0.500"
滚子直径 Roller	0.312"
内节内宽 Internal width	0.312"

链轮尺寸 Sprocket Size

齿端圆弧R3 Tooth radius	0.511"
圆弧深度C Radius width	0.051"
齿宽B1 Tooth width	0.284"

■ A型

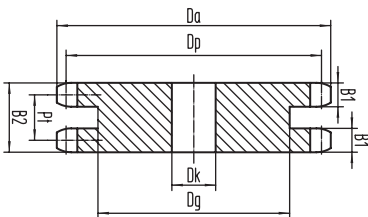

■ B型

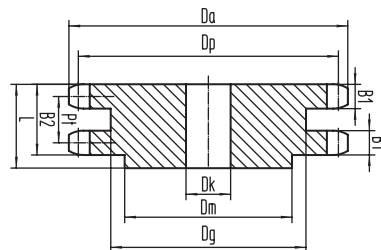

齿数 tooth number	节圆径 Pitch diameter	齿顶圆 addendum circle	A型		B型	
			孔径 bore diameter	凸台 boss	孔径 bore diameter	总厚度 aggregate thickness
Z	Dp	Da	Dk	dm	Dk	L
8	1.307	1.510		0.984	0.500	0.875
9	1.462	1.670		1.063	0.500	0.875
10	1.619	1.840		1.250	0.500	0.875
11	1.775	2.000		1.375	0.500	0.875
12	1.932	2.170	0.500	1.563	0.500	0.875
13	2.090	2.330	0.500	1.688	0.500	0.875
14	2.247	2.490	0.500	1.813	0.500	0.875
15	2.405	2.650	0.625	2.000	0.500	0.875
16	2.563	2.810	0.625	2.125	0.625	0.875
17	2.722	2.970	0.625	2.313	0.625	1.000
18	2.880	3.140	0.625	2.500	0.625	1.000
19	3.038	3.300	0.625	2.625	0.625	1.000
20	3.197	3.460	0.625	2.750	0.625	1.000
21	3.355	3.620	0.625	2.875	0.625	1.000
22	3.514	3.780	0.625	3.000	0.625	1.000
23	3.672	3.940	0.625	3.250	0.625	1.000
24	3.831	4.100	0.625	3.250	0.625	1.000
25	3.990	4.260	0.625	3.250	0.625	1.000
26	4.149	4.420	0.625	3.250	0.625	1.000
27	4.307	4.580	0.625	3.250	0.625	1.000
28	4.466	4.740	0.625	3.250	0.625	1.000
29	4.625	4.900	0.594	3.250	0.625	1.000
30	4.784	5.060	0.594	3.250	0.625	1.000
31	4.943	5.220	0.594	3.250	0.625	1.000
32	5.102	5.380	0.594	3.250	0.625	1.000
33	5.261	5.540	0.594	3.250	0.625	1.000
34	5.419	5.700	0.594	3.250	0.625	1.000
35	5.578	5.860	0.594	3.250	0.625	1.000
36	5.737	6.020	0.594	3.250	0.625	1.000
37	5.896	6.170	0.594	3.250	0.625	1.000
38	6.055	6.330	0.594	3.250	0.625	1.000
39	6.214	6.490	0.594	3.250	0.625	1.000
40	6.373	6.650	0.719	3.500	0.750	1.125
41	6.532	6.810	0.719	3.500	0.750	1.125

齿数 tooth number	节圆径 Pitch diameter	齿顶圆 addendum circle	A型		B型	
			孔径 bore diameter	凸台 boss	孔径 bore diameter	总厚度 aggregate thickness
Z	Dp	Da	Dk	dm	Dk	L
42	6.691	6.970	0.719	3.500	0.750	1.125
43	6.850	7.130	0.719	3.500	0.750	1.125
44	7.009	7.290	0.719	3.500	0.750	1.125
45	7.168	7.450	0.719	3.500	0.750	1.125
46	7.327	7.610	0.719	3.500	0.750	1.125
47	7.486	7.770	0.719	3.500	0.750	1.125
48	7.645	7.930	0.719	3.500	0.750	1.125
49	7.804	8.090	0.719	3.500	0.750	1.125
50	7.963	8.250	0.719	3.500	0.750	1.125
51	8.123	8.410	0.719	3.500	0.750	1.125
52	8.282	8.570	0.719	3.500	0.750	1.125
53	8.441	8.730	0.719	3.500	0.750	1.125
54	8.600	8.880	0.719	3.500	0.750	1.125
55	8.759	9.040	0.719	3.500	0.750	1.125
56	8.918	9.200	0.719	3.500	0.750	1.125
57	9.077	9.360	0.719	3.500	0.750	1.125
58	9.236	9.520	0.719	3.500	0.750	1.125
59	9.395	9.680	0.719	3.500	0.750	1.125
60	9.554	9.840	0.719	3.500	0.750	1.125
61	9.713	10.000	0.719	4.000	0.750	1.250
62	9.872	10.160	0.719	4.000	0.750	1.250
63	10.031	10.320	0.719	4.000	0.750	1.250
64	10.191	10.480	0.719	4.000	0.750	1.250
65	10.350	10.640	0.719	4.000	0.750	1.250
66	10.509	10.800	0.719	4.000	0.750	1.250
67	10.668	10.960	0.719	4.000	0.750	1.250
68	10.827	11.110	0.719	4.000	0.750	1.250
69	10.986	11.270	0.719	4.000	0.750	1.250
70	11.145	11.430	0.719	4.000	0.750	1.250
72	11.463	11.750	0.719	4.000	0.750	1.250
80	12.736	13.030	0.719	4.000	0.750	1.250
84	13.373	13.660	0.719	4.000	0.750	1.250
96	15.282	15.570	0.938	4.000	1.000	1.250
112	17.828	18.120	0.938	4.000	1.000	1.250

注: 1. 外形尺寸按上表, 齿部参数在不指明的情况按照 ISO 606 加工。其余标准: DIN 8187/ BS 228 /JIS 1802

2. 材质: 不指定则为 45 GB/T699

3. 带“*”的凸缘为焊接件。

双排链轮 ISO/R 10A ANSI 50 Sprockets for Roller Chains-Duplex

配套链条尺寸 Chain Size

节距 Pitch	0.625"
滚子直径 Roller	0.400"
内节内宽 Internal width	0.375"

链轮尺寸 Sprocket Size

齿端圆弧R3 Tooth radius	0.669"
圆弧深度C Radius width	0.063"
齿宽B1 Tooth width	0.343"

A 型

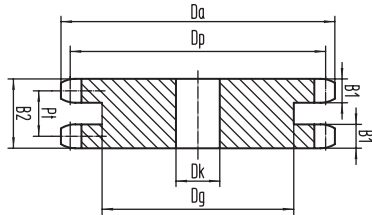

B 型

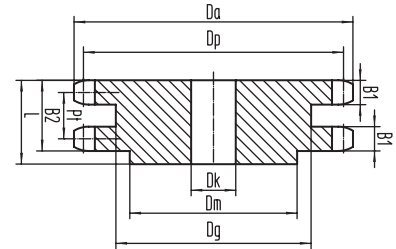

齿数 tooth number	节圆径 Pitch diameter	齿顶圆 addendum circle	A 型			B 型			齿数 tooth number	节圆径 Pitch diameter	齿顶圆 addendum circle	A 型			B 型					
			孔径 bore diameter	凸台 boss	孔径 bore diameter	总厚度 aggregate thickness	孔径 bore diameter	凸台 boss				孔径 bore diameter	总厚度 aggregate thickness	孔径 bore diameter	凸台 boss	孔径 bore diameter	总厚度 aggregate thickness			
Z	Dp	Da	Dk	dm	Dk	L	Z	Dp	Da	Dk	dm	Dk	L	Z	Dp	Da	Dk	dm	Dk	L
8	1.634	1.880		1.125	0.625	1.000	42	8.364	8.720	0.719	3.250	0.750	1.250							
9	1.828	2.090		1.375	0.625	1.000	43	8.563	8.910	0.719	3.250	0.750	1.250							
10	2.023	2.300		1.563	0.625	1.000	44	8.761	9.110	0.719	3.250	0.750	1.250							
11	2.219	2.500		1.750	0.625	1.000	45	8.960	9.310	0.719	3.750	0.750	1.250							
12	2.415	2.710	0.625	1.984	0.625	1.000	46	9.159	9.510	0.938	3.750	1.000	1.250							
13	2.612	2.910	0.625	1.875	0.625	1.000	47	9.358	9.710	0.938	3.750	1.000	1.250							
14	2.809	3.110	0.625	2.125	0.625	1.000	48	9.557	9.910	0.938	3.750	1.000	1.250							
15	3.007	3.320	0.625	2.375	0.625	1.000	49	9.755	10.110	0.938	3.750	1.000	1.250							
16	3.204	3.520	0.625	2.500	0.625	1.000	50	9.954	10.310	0.938	3.750	1.000	1.250							
17	3.402	3.720	0.625	2.688	0.625	1.000	51	10.153	10.510	0.938	3.750	1.000	1.250							
18	3.600	3.920	0.625	2.875	0.625	1.000	52	10.352	10.710	0.938	3.750	1.000	1.250							
19	3.798	4.120	0.625	3.000	0.625	1.000	53	10.551	10.910	0.938	3.750	1.000	1.250							
20	3.996	4.320	0.750	3.000	0.750	1.000	54	10.750	11.110	0.938	3.750	1.000	1.250							
21	4.194	4.520	0.750	3.000	0.750	1.000	55	10.948	11.300	0.938	3.750	1.000	1.250							
22	4.392	4.720	0.750	3.000	0.750	1.000	56	11.147	11.500	0.938	3.750	1.000	1.250							
23	4.590	4.920	0.750	3.000	0.750	1.000	57	11.346	11.700	0.938	3.750	1.000	1.250							
24	4.789	5.120	0.719	3.000	0.750	1.250	58	11.545	11.900	0.938	3.750	1.000	1.250							
25	4.987	5.320	0.719	3.000	0.750	1.250	59	11.744	12.100	0.938	3.750	1.000	1.250							
26	5.186	5.520	0.719	3.000	0.750	1.250	60	11.943	12.300	0.938	3.750	1.000	1.250							
27	5.384	5.720	0.719	3.000	0.750	1.250	61	12.141	12.500	0.938	3.750	1.000	1.750							
28	5.583	5.920	0.719	3.000	0.750	1.250	62	12.340	12.700	0.938	3.750	1.000	1.750							
29	5.781	6.120	0.719	3.000	0.750	1.250	63	12.539	12.900	0.938	3.750	1.000	1.750							
30	5.980	6.320	0.719	3.250	0.750	1.250	64	12.738	13.100	0.938	3.750	1.000	1.750							
31	6.178	6.520	0.719	3.250	0.750	1.250	65	12.937	13.300	0.938	3.750	1.000	1.750							
32	6.377	6.720	0.719	3.250	0.750	1.250	66	13.136	13.500	0.938	3.750	1.000	1.750							
33	6.576	6.920	0.719	3.250	0.750	1.250	67	13.335	13.690	0.938	3.750	1.000	1.750							
34	6.774	7.120	0.719	3.250	0.750	1.250	68	13.533	13.890	0.938	3.750	1.000	1.750							
35	6.973	7.320	0.719	3.250	0.750	1.250	69	13.732	14.090	0.938	3.750	1.000	1.750							
36	7.172	7.520	0.719	3.250	0.750	1.250	70	13.931	14.290	0.938	3.750	1.000	1.750							
37	7.370	7.720	0.719	3.250	0.750	1.250	72	14.329	14.690	0.938	3.750	1.000	1.750							
38	7.569	7.920	0.719	3.250	0.750	1.250	80	15.920	16.280	0.938	4.250	1.000	1.750							
39	7.768	8.120	0.719	3.250	0.750	1.250	84	16.716	17.080	0.938	4.250	1.000	1.750							
40	7.966	8.320	0.719	3.250	0.750	1.250	96	19.103	19.470	0.938	4.250	1.000	1.750							
41	8.165	8.520	0.719	3.250	0.750	1.250	112	22.285	22.650	0.938	4.250	1.000	1.750							

注: 1. 外形尺寸按上表, 齿部参数在不指明的情况按照 ISO 606 加工。其余标准: DIN 8187/ BS 228 /JIS 1802

2. 材质: 不指定则为 45 GB/T699

3. 带“*”的凸缘为焊接件。

A系列滚子链轮 Sprocket For Roller Chain-A Series

双排链轮 ISO/R 12A ANSI 60 Sprockets for Roller Chains-Duplex

配套链条尺寸 Chain Size

节距 Pitch	0.750"
滚子直径 Roller	0.469"
内节内宽 Internal width	0.500"

链轮尺寸 Sprocket Size

齿端圆弧R3 Tooth radius	0.787"
圆弧深度C Radius width	0.079"
齿宽B1 Tooth width	0.459"

■ A型

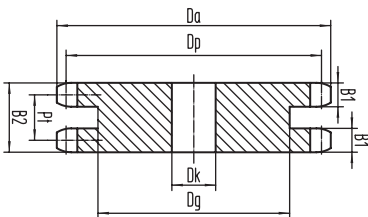

■ B型

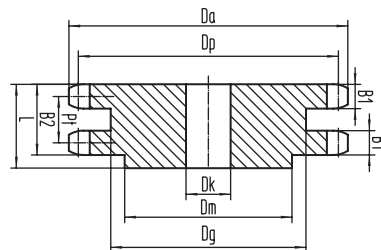

齿数 tooth number	节圆径 Pitch diameter	齿顶圆 addendum circle	A型		B型		齿数 tooth number	节圆径 Pitch diameter	齿顶圆 addendum circle	A型		B型	
			孔径 bore diameter	凸台 boss	孔径 bore diameter	总厚度 aggregate thickness				孔径 bore diameter	凸台 boss	孔径 bore diameter	总厚度 aggregate thickness
Z	Dp	Da	Dk	dm	Dk	L	Z	Dp	Da	Dk	dm	Dk	L
8	1.960	2.260		1.469	0.625	1.250	42	10.037	10.460	0.938	4.250	1.000	1.250
9	2.193	2.510		1.563	0.750	1.250	43	10.275	10.700	0.938	4.250	1.000	1.250
10	2.428	2.760	0.750	1.938	0.750	1.250	44	10.514	10.940	0.938	4.250	0.938	1.250
11	2.663	3.000	0.750	2.063	0.750	1.250	45	10.752	11.180	0.938	4.250	0.938	1.250
12	2.898	3.250	0.750	2.375	0.750	1.250	46	10.991	11.410	0.938	4.250	0.938	1.250
13	3.134	3.490	0.750	2.344	0.750	1.250	47	11.229	11.650	0.938	4.250	0.938	1.250
14	3.371	3.740	0.750	2.563	0.750	1.250	48	11.468	11.890	0.938	4.250	0.938	1.250
15	3.608	3.980	0.750	2.875	0.750	1.250	49	11.706	12.130	0.938	4.250	0.938	1.250
16	3.845	4.220	0.750	3.063	0.750	1.250	50	11.945	12.370	0.938	4.250	0.938	1.250
17	4.082	4.460	0.750	3.250	0.750	1.250	51	12.184	12.610	0.938	4.250	0.938	1.250
18	4.320	4.700	0.750	3.500	0.750	1.250	52	12.422	12.850	0.938	4.250	0.938	1.250
19	4.557	4.940	0.750	3.500	0.750	1.250	53	12.661	13.090	0.938	4.250	0.938	1.250
20	4.795	5.190	0.750	3.875	0.750	1.250	54	12.899	13.330	0.938	4.250	0.938	1.750
21	5.033	5.430	0.750	4.000	0.750	1.250	55	13.138	13.570	1.250	4.250	1.250	1.750
22	5.271	5.670	0.750	4.000	0.750	1.250	56	13.377	13.800	1.250	4.250	1.250	1.750
23	5.508	5.910	0.750	4.000	0.750	1.250	57	13.615	14.040	1.250	4.250	1.250	1.750
24	5.746	6.150	0.719	4.000	0.750	1.250	58	13.854	14.280	1.250	4.250	1.250	1.750
25	5.985	6.390	0.719	4.000	0.750	1.250	59	14.092	14.520	1.250	4.250	1.250	1.750
26	6.223	6.630	0.719	4.000	0.750	1.250	60	14.331	14.760	1.250	4.250	1.250	1.750
27	6.461	6.870	0.719	4.000	0.750	1.250	61	14.570	15.000	1.250	4.250	1.250	1.750
28	6.699	7.110	0.719	4.000	0.750	1.250	62	14.808	15.240	1.250	4.250	1.250	1.750
29	6.937	7.350	0.719	4.000	0.750	1.250	63	15.047	15.480	1.250	4.250	1.250	1.750
30	7.176	7.590	0.719	4.000	0.750	1.250	64	15.286	15.720	1.250	4.250	1.250	1.750
31	7.414	7.830	0.719	4.000	0.750	1.250	65	15.524	15.960	1.250	4.250	1.250	1.750
32	7.652	8.060	0.719	4.000	0.750	1.250	66	15.763	16.190	1.250	4.250	1.250	1.750
33	7.891	8.300	0.938	4.000	1.000	1.250	68	16.240	16.670	1.250	4.250	1.250	1.750
34	8.129	8.540	0.938	4.000	1.000	1.250	70	16.717	17.150	1.250	4.250	1.250	1.750
35	8.367	8.780	0.938	4.000	1.000	1.250	72	17.195	17.630	1.250	4.250	1.250	2.000
36	8.606	9.020	0.938	4.000	1.000	1.250	76	18.149	18.580	1.250	4.250	1.250	2.000
37	8.844	9.260	0.938	4.000	1.000	1.250	80	19.104	19.540	1.250	4.250	1.250	2.000
38	9.083	9.500	0.938	4.250	1.000	1.250	84	20.059	20.490	1.250	4.750	1.250	2.000
39	9.321	9.740	0.938	4.250	1.000	1.250	90	21.491	21.930	1.250	5.000	1.250	2.250
40	9.560	9.980	0.938	4.250	1.000	1.250	96	22.923	23.360	1.250	5.250	1.250	2.250
41	9.798	10.220	0.938	4.250	1.000	1.250	112	26.742	27.180	1.250	5.250	1.250	2.250

注: 1. 外形尺寸按上表, 齿部参数在不指明的情况按照 ISO 606 加工。其余标准: DIN 8187/ BS 228 /JIS 1802

2. 材质: 不指定则为 45 GB/T699

3. 带“*”的凸缘为焊接件。

双排链轮 ISO/R 16A ANSI 80 Sprockets for Roller Chains-Duplex

配套链条尺寸 Chain Size

节距 Pitch	1.000"
滚子直径 Roller	0.625"
内节内宽 Internal width	0.625"

链轮尺寸 Sprocket Size

齿端圆弧R3 Tooth radius	1.024"
圆弧深度C Radius width	0.098"
齿宽B1 Tooth width	0.575"

A 型

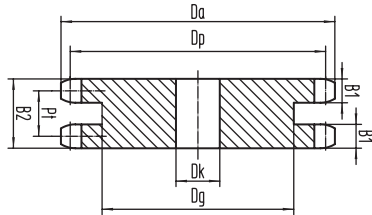

B 型

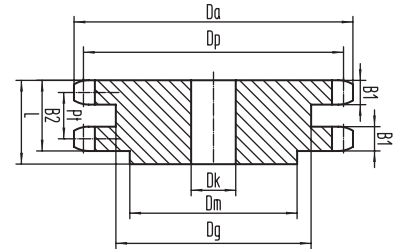

齿数 tooth number	节圆径 Pitch diameter	齿顶圆 addendum circle	A 型		B 型		齿数 tooth number	节圆径 Pitch diameter	齿顶圆 addendum circle	A 型		B 型	
			孔径 bore diameter	凸台 boss	孔径 bore diameter	总厚度 aggregate thickness				孔径 bore diameter	凸台 boss	孔径 bore diameter	总厚度 aggregate thickness
Z	Dp	Da	Dk	dm	Dk	L	Z	Dp	Da	Dk	dm	Dk	L
8	2.614	3.010		1.938	1.000	1.625	42	13.382	13.940	1.250	4.750	1.250	2.000
9	2.924	3.350	0.938	2.250	1.000	1.625	43	13.700	14.260	1.250	4.750	1.250	2.000
10	3.237	3.680	0.938	2.563	1.000	1.625	44	14.018	14.580	1.250	4.750	1.250	2.000
11	3.550	4.010	0.938	2.813	1.000	1.625	45	14.336	14.900	1.250	4.750	1.250	2.000
12	3.864	4.330	0.938	3.125	1.000	1.625	46	14.654	15.220	1.250	4.750	1.250	2.000
13	4.179	4.660	0.938	3.000	1.000	1.500	47	14.972	15.540	1.250	4.750	1.250	2.000
14	4.494	4.980	0.938	3.250	1.000	1.500	48	15.290	15.860	1.250	4.750	1.250	2.000
15	4.810	5.300	0.938	3.813	1.000	1.500	49	15.608	16.180	1.250	4.750	1.250	2.000
16	5.126	5.630	0.938	4.000	1.000	1.500	50	15.926	16.490	1.250	4.750	1.250	2.000
17	5.443	5.950	0.938	4.000	1.000	1.500	51	16.245	16.810	1.250	4.750	1.250	2.000
18	5.759	6.270	0.938	4.250	1.000	1.500	52	16.563	17.130	1.250	4.750	1.250	2.000
19	6.076	6.590	0.938	4.250	1.000	1.500	53	16.881	17.450	1.250	5.250	1.250	2.000
20	6.393	6.910	0.938	4.250	1.000	1.500	54	17.199	17.770	1.250	5.250	1.250	2.000
21	6.710	7.230	0.938	4.250	1.000	1.750	55	17.517	18.090	1.250	5.250	1.250	2.000
22	7.027	7.560	0.938	4.250	1.000	1.750	56	17.835	18.410	1.250	5.250	1.250	2.000
23	7.344	7.880	0.938	4.250	1.000	1.750	57	18.153	18.730	1.250	5.250	1.250	2.000
24	7.662	8.200	0.938	4.250	1.000	1.750	58	18.472	19.040	1.250	5.250	1.250	2.000
25	7.979	8.520	0.938	4.250	1.000	1.750	59	18.790	19.360	1.250	5.250	1.250	2.000
26	8.297	8.840	1.188	4.750	1.250	2.000	60	19.108	19.680	1.250	5.250	1.250	2.000
27	8.614	9.160	1.188	4.750	1.250	2.000	61	19.426	20.000	1.250	5.250	1.250	2.000
28	8.932	9.480	1.188	4.750	1.250	2.000	62	19.744	20.320	1.250	5.250	1.250	2.000
29	9.250	9.790	1.188	4.750	1.188	2.000	63	20.062	20.640	1.250	5.250	1.250	2.000
30	9.567	10.110	1.188	4.750	1.188	2.000	64	20.381	20.960	1.250	5.250	1.250	2.000
31	9.885	10.430	1.188	4.750	1.188	2.000	65	20.699	21.270	1.250	5.250	1.250	2.000
32	10.203	10.750	1.188	4.750	1.188	2.000	66	21.017	21.590	1.500	6.250	1.500	3.500
33	10.521	11.070	1.188	4.750	1.188	2.000	68	21.653	22.230	1.500	6.250	1.500	3.500
34	10.838	11.390	1.188	4.750	1.188	2.000	70	22.290	22.870	1.500	6.250	1.500	3.500
35	11.156	11.710	1.188	4.750	1.188	2.000	72	22.926	23.500	1.500	6.250	1.500	3.500
36	11.474	12.030	1.188	4.750	1.188	2.000	76	24.199	24.780	1.500	6.250	1.500	3.500
37	11.792	12.350	1.188	4.750	1.188	2.000	80	25.472	26.050	1.500	6.250	1.500	3.500
38	12.110	12.670	1.188	4.750	1.188	2.000	84	26.745	27.330	1.500	6.250	1.500	3.500
39	12.428	12.990	1.188	4.750	1.188	2.000	90	28.654	29.240	1.500	6.250	1.500	3.500
40	12.746	13.310	1.188	4.750	1.188	2.000	96	30.564	31.150	1.500	6.250	1.500	3.500
41	13.064	13.630	1.250	4.750	1.250	2.000	112	35.656	36.240	1.500	6.250	1.500	3.500

注: 1. 外形尺寸按上表, 齿部参数在不指明的情况按照 ISO 606 加工。其余标准: DIN 8187/ BS 228 /JIS 1802

2. 材质: 不指定则为 45 GB/T699

3. 带“*”的凸缘为焊接件。

A系列滚子链轮 Sprocket For Roller Chain-A Series

单排链轮 ISO/R 20A ANSI 100 Sprockets for Roller Chains-Simplex

配套链条尺寸 Chain Size

节距 Pitch	1.250"
滚子直径 Roller	0.750"
内节内宽 Internal width	0.750"

链轮尺寸 Sprocket Size

齿端圆弧R3 Tooth radius	1.260"
圆弧深度C Radius width	0.138"
齿宽B1 Tooth width	0.692"

A 型

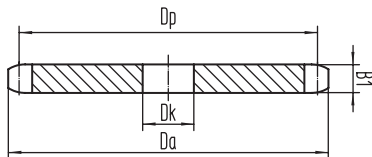

B 型

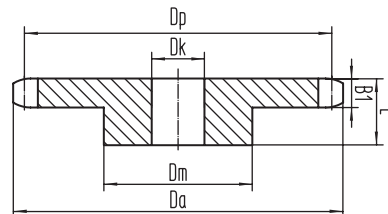

齿数 tooth number	节圆径 Pitch diameter	齿顶圆 addendum circle	A 型		B 型	
			孔径 bore diameter	凸台 boss	孔径 bore diameter	总厚度 aggregate thickness
Z	Dp	Da	Dk	dm	Dk	L
7	2.881	3.350	1.000			
8	3.267	3.770	1.000	2.438	1.000	1.875
9	3.655	4.180	1.000	2.813	1.000	1.875
10	4.046	4.600	1.000	3.250	1.000	1.875
11	4.437	5.010	1.250	3.563	1.000	1.875
12	4.830	5.420	1.250	4.000	1.000	1.875
13	5.224	5.820	1.250	3.875	1.000	1.625
14	5.618	6.230	1.250	4.188	1.250	1.625
15	6.013	6.630	1.250	4.500	1.250	1.750
16	6.408	7.030	1.250	4.500	1.313	1.750
17	6.803	7.440	1.250	4.500	1.313	1.750
18	7.199	7.840	1.250	4.500	1.313	1.750
19	7.595	8.240	1.250	4.500	1.313	2.000
20	7.991	8.640	1.250	4.500	1.313	2.000
21	8.387	9.040	1.250	4.500	1.313	2.000
22	8.784	9.440	1.250	4.500	1.313	2.000
23	9.180	9.840	1.250	4.500	1.250	2.000
24	9.577	10.240	1.250	4.500	1.250	2.000
25	9.974	10.640	1.250	4.500	1.250	2.000
26	10.371	11.040	1.250	5.000	1.250	2.000
27	10.768	11.440	1.250	5.000	1.250	2.000
28	11.165	11.840	1.250	5.000	1.250	2.000
29	11.562	12.240	1.250	5.000	1.250	2.000
30	11.959	12.640	1.250	5.000	1.250	2.000
31	12.356	13.040	1.250	5.000	1.250	2.000
32	12.753	13.440	1.250	5.000	1.250	2.000
33	13.151	13.840	1.250	5.000	1.250	2.000
34	13.548	14.240	1.250	5.000	1.250	2.000
35	13.945	14.640	1.250	5.000	1.250	2.500
36	14.343	15.040	1.250	5.000	1.250	2.500
37	14.740	15.440	1.250	5.000	1.250	2.500
38	15.137	15.840	1.250	5.000	1.250	2.500
39	15.535	16.230	1.250	5.000	1.250	2.500
40	15.932	16.630	1.250	5.000	1.250	2.500

齿数 tooth number	节圆径 Pitch diameter	齿顶圆 addendum circle	A 型		B 型	
			孔径 bore diameter	凸台 boss	孔径 bore diameter	总厚度 aggregate thickness
Z	Dp	Da	Dk	dm	Dk	L
41	16.330	17.030	1.250	5.000	1.250	2.500
42	16.727	17.430	1.250	5.000	1.250	2.500
43	17.125	17.830	1.500	5.000	1.500	2.500
44	17.522	18.230	1.500	5.000	1.500	2.500
45	17.920	18.630	1.500	5.000	1.500	2.500
46	18.318	19.020	1.500	5.000	1.500	2.500
47	18.715	19.420	1.500	6.000	1.500	2.500
48	19.113	19.820	1.500	6.000	1.500	2.500
49	19.510	20.220	1.500	6.000	1.500	2.500
50	19.908	20.620	1.500	6.000	1.500	2.500
51	20.306	21.020	1.500	6.000	1.500	3.250
52	20.703	21.410	1.500	6.000	1.500	3.250
53	21.101	21.810	1.500	6.000	1.500	3.250
54	21.499	22.210	1.500	6.000	1.500	3.250
55	21.896	22.610	1.500	6.000	1.500	3.250
56	22.294	23.010	1.500	6.000	1.500	3.250
57	22.692	23.410	1.500	6.000	1.500	3.250
58	23.089	23.800	1.500	6.000	1.500	3.250
59	23.487	24.200	1.500	6.000	1.500	3.250
60	23.885	24.600	1.500	6.000	1.500	3.250
61	24.282	25.000	1.500	7.000	1.500	3.750
62	24.680	25.400	1.500	7.000	1.500	3.750
63	25.078	25.800	1.500	7.000	1.500	3.750
64	25.476	26.190	1.500	7.000	1.500	3.750
65	25.873	26.590	1.500	7.000	1.500	3.750
66	26.271	26.990	1.500	7.000	1.500	3.750
68	27.066	27.790	1.500	7.000	1.500	3.750
70	27.862	28.580	1.500	7.000	1.500	3.750
72	28.657	29.380	1.500	7.000	1.500	3.750
76	30.249	30.970	1.500	7.000	1.500	3.750
80	31.840	32.560	1.500	7.000	1.500	3.750
84	33.431	34.160	1.500	7.000	1.500	3.750
90	35.818	36.550	1.500	7.000	1.500	3.750
96	38.205	38.930	1.500	7.000	1.500	4.500

注: 1. 外形尺寸按上表, 齿部参数在不指明的情况按照 ISO 606 加工。其余标准: DIN 8187/ BS 228 /JIS 1802

2. 材质: 不指定则为 45 GB/T699

3. 带“*”的凸缘为焊接件。

双排链轮 ISO/R 24A ANSI 120 Sprockets for Roller Chains-Duplex

配套链条尺寸 Chain Size

节距 Pitch	1.500"
滚子直径 Roller	0.875"
内节内宽 Internal width	1.000"

链轮尺寸 Sprocket Size

齿端圆弧R3 Tooth radius	1.496"
圆弧深度C Radius width	0.157"
齿宽B1 Tooth width	0.924"

A 型

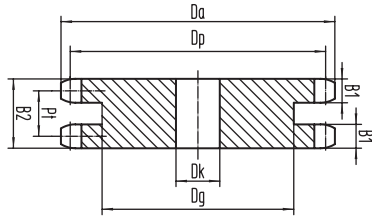

B 型

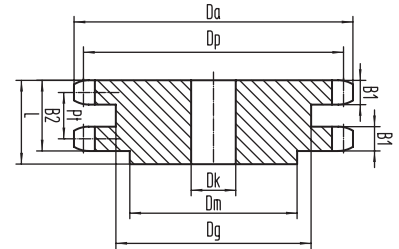

齿数 tooth number	节圆径 Pitch diameter	齿顶圆 addendum circle	A 型			B 型							
			孔径 bore diameter	凸台 boss	孔径 bore diameter	总厚度 aggregate thickness	孔径 bore diameter	凸台 boss	孔径 bore diameter	总厚度 aggregate thickness			
Z	Dp	Da	Dk	dm	Dk	L	Z	Dp	Da	Dk	dm	Dk	L
7	2.881	3.350	1.250				41	16.330	17.030	1.500	6.000	1.500	3.750
8	3.267	3.770	1.250				42	16.727	17.430	1.500	6.000	1.500	3.750
9	3.655	4.180	1.250	3.375	1.375	2.250	43	17.125	17.830	1.500	6.000	1.500	3.750
10	4.046	4.600	1.250	3.750	1.375	2.250	44	17.522	18.230	1.500	6.000	1.500	3.750
11	4.437	5.010	1.250	3.563	1.375	2.125	45	17.920	18.630	1.500	6.000	1.500	3.750
12	4.830	5.420	1.250	4.125	1.375	2.250	46	18.318	19.020	1.500	6.000	1.500	4.000
13	5.224	5.820	1.250	4.563	1.375	2.250	47	18.715	19.420	1.500	6.000	1.500	4.000
14	5.618	6.230	1.250	4.750	1.375	2.375	48	19.113	19.820	1.500	6.000	1.500	4.000
15	6.013	6.630	1.250	4.750	1.250	2.375	49	19.510	20.220	1.500	6.000	1.500	4.000
16	6.408	7.030	1.250	5.250	1.250	2.375	50	19.908	20.620	1.500	6.000	1.500	4.000
17	6.803	7.440	1.250	5.250	1.250	2.375	51	20.306	21.020	1.500	6.000	1.500	4.000
18	7.199	7.840	1.250	5.250	1.250	2.375	52	20.703	21.410	1.500	6.000	1.500	4.000
19	7.595	8.240	1.250	5.250	1.250	2.375	53	21.101	21.810	1.500	6.000	1.500	4.000
20	7.991	8.640	1.250	5.250	1.250	2.375	54	21.499	22.210	1.500	6.000	1.500	4.000
21	8.387	9.040	1.250	5.250	1.250	2.375	55	21.896	22.610	1.500	7.000	1.500	4.000
22	8.784	9.440	1.250	5.250	1.250	2.375	56	22.294	23.010	1.500	7.000	1.500	4.000
23	9.180	9.840	1.250	5.250	1.250	2.375	57	22.692	23.410	1.500	7.000	1.500	4.000
24	9.577	10.240	1.250	5.250	1.250	2.375	58	23.089	23.800	1.500	7.000	1.500	4.000
25	9.974	10.640	1.250	5.250	1.250	2.375	59	23.487	24.200	1.500	7.000	1.500	4.000
26	10.371	11.040	1.500	6.000	1.500	2.500	60	23.885	24.600	1.500	7.000	1.500	4.000
27	10.768	11.440	1.500	6.000	1.500	2.500	62	24.680	25.400	1.500	7.500	1.500	4.500
28	11.165	11.840	1.500	6.000	1.500	2.500	64	25.476	26.190	1.500	7.500	1.500	4.500
29	11.562	12.240	1.500	6.000	1.500	2.500	66	26.271	26.990	1.500	7.500	1.500	4.500
30	11.959	12.640	1.500	6.000	1.500	2.500	68	27.066	27.790	1.500	7.500	1.500	4.500
31	12.356	13.040	1.500	6.000	1.500	2.500	70	27.862	28.580	1.500	7.500	1.500	4.500
32	12.753	13.440	1.500	6.000	1.500	2.500	72	28.657	29.380	1.500	7.500	1.500	4.500
33	13.151	13.840	1.500	6.000	1.500	2.500	74	29.453	30.180	1.500	7.500	1.500	4.500
34	13.548	14.240	1.500	6.000	1.500	2.500	76	30.249	30.970	1.500	7.500	1.500	4.500
35	13.945	14.640	1.500	6.000	1.500	2.500	78	31.044	31.770	1.500	7.500	1.500	4.500
36	14.343	15.040	1.500	6.000	1.500	2.500	90	35.818	36.550	1.500	7.500	1.500	4.500
37	14.740	15.440	1.500	6.000	1.500	3.750	82	32.635	33.360	1.500	7.500	1.500	4.500
38	15.137	15.840	1.500	6.000	1.500	3.750	84	33.431	34.160	1.500	7.500	1.500	4.500
39	15.535	16.230	1.500	6.000	1.500	3.750	86	34.226	34.950	1.500	7.500	1.500	4.500
40	15.932	16.630	1.500	6.000	1.500	3.750	90	35.818	36.550	1.500	7.500	1.500	4.500

注: 1. 外形尺寸按上表, 齿部参数在不指明的情况按照 ISO 606 加工。其余标准: DIN 8187/ BS 228 /JIS 1802

2. 材质: 不指定则为 45 GB/T699

3. 带 "*" 的凸缘为焊接件。